

PEAK MARQUEE™ TENT MQ30

10567 Frame Assembly with Aluminum Tubes
10606 Frame Assembly with Steel Tubes

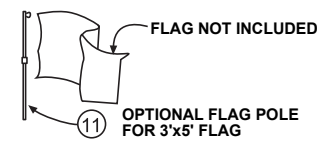

ANCHOR LOAD GUIDE

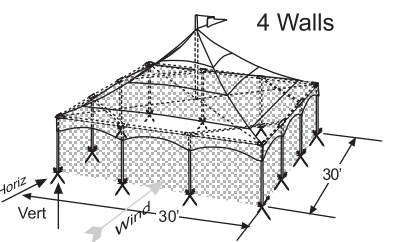
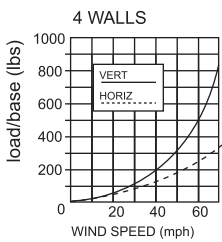
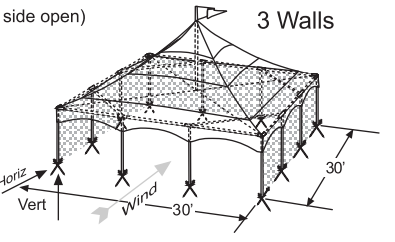
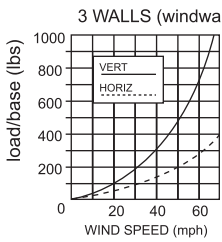
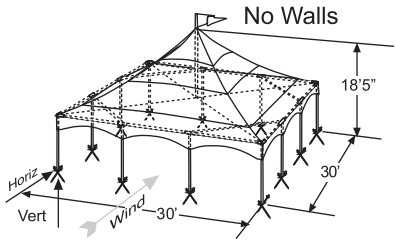
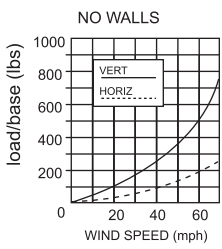

#6857 QUICKLINK can be ordered separately

CAUTION: Tension straps must be maintained tight and even for proper tensioning of the canopy fabric. The fabric must remain taut to avoid rain ponding.

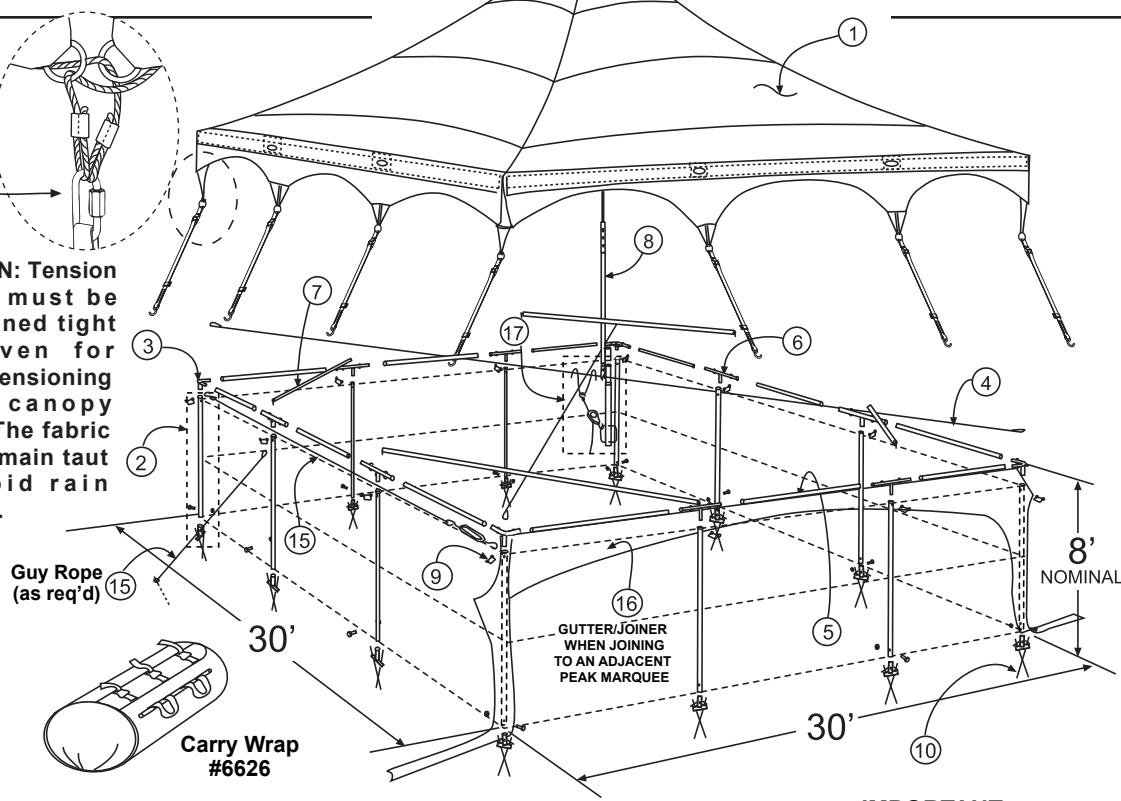

*WIND SPEED - is the wind directly on the tent. The wind speed reported through the media is usually measured 33' above ground at a local airport weather station. Wind load on your tent may be reduced considerably by topography, trees, buildings, fences and other adjacent roughness.

IMPORTANT: Each installation site must be evaluated by installer to determine proper securing method. Site conditions may require anchorage different from what was provided with the tent.

* Guy ropes should be used in high wind areas.

To increase anchorage and stability, guy ropes are recommended. Much of the anchor loading may be transferred from the post base to the guy anchors.

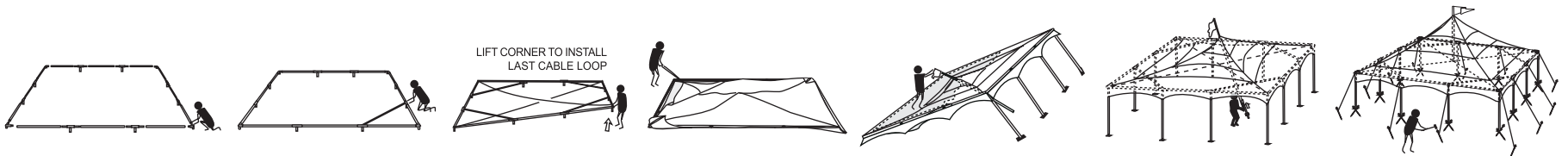

CANOPY		PART	PART NO.	QTY
① TOP		Top	#10624	1
		Quicklink	#6857	12
		Tension Strap	#15050	12
FRAME				
② POST ASSEMBLY		Base	#10514	12
		Post alum	#10591	12
		Post steel	#10590	12
		Bolts	#4093	12
	Nuts	#8369	12	
③ CORNER 90°		Corner 90°	#10628	4
④ CROSS CABLE		Cross Cable	#7160	2
⑤ EVE TUBES		Eve Tube		12
		alum	#10630	
	steel	#7161		
⑥ T-JOINT		T-joint		8
	alum	#10654		
⑦ BRACE DIAGONAL		Brace		4
		alum	#10757	
	steel	#7157		
⑧ CENTREPOLE ASSEMBLY		Centre pole	#10598	1
⑨ LOCKPIN		Lock Pin	#7843	13

OPTIONS		PART NO.	QTY
⑩ STAKE 3/4" x 34"		#10666	24
⑪ FLAG POLE EXT.		#9523	1
⑫ DROP SHEET		#10587	1
⑬ CABLE: 30' SLIDE WALL		(30') #11004	AS REQ'D
⑭ BASE: ADJ. 24"		#11064	12
⑮ GUY ROPE		#10689	AS REQ'D
⑯ GUTTER/JOINER		(30') #11006	AS REQ'D
⑰ CENTREPOLE TOOL/CABLE		#10324	1
		#10325	1
REPAIR KIT for Vinyl Tops		#6844	-

Please call on our 800 line with any questions or concerns:



Toll-free: 1-800-661-6155
Phone: (403) 279-7662
Fax: (403) 236-2633
Web: www.wssl.com
Email: warner@wssl.com

STRUCTURES & TENTS
9811 - 44th St, SE, Calgary, Alberta, Canada T2C 2P7